

NATIONAL MUSEUM OF ROMANIAN JEWRY AND THE HOLOCAUST

Design Competition of
The Permanent Exhibition
and Auxiliary Spaces





BRIEF

In August 2016, the `Elie Wiesel` National Institute for the Study of the Holocaust in Romania was designated by the Romanian Government, to coordinate the activities required to implement the **Museum of the Romanian Jewry and the Holocaust in Romania.**

Our **mission** is to challenge and inspire audiences through the discovery of the past, to encourage understanding of history and give impetus to make an important step towards accountability and tolerance.

We want to create a **modern museum, an educational and cultural center** that represents a platform for civic and intercultural dialogue. We want the museum to offer a unique experience to the visitor and impose a new standard in the perception of the culture and history of the Jewish community.

The Museum aims to **promote the history, culture, and traditions of the Jewish community in Romania**, and highlight the contribution of this national minority to the evolution of the Romanian society over time. During the interwar period, Romania had the third largest Jewish community in Europe, after Poland and the Soviet Union. The presentation of the tragedy of discrimination, deportation and mass murder of the Jewish population during the Holocaust is another strong argument for the creation of the museum.

BRIEF

Through **modern** and **interactive** means, the exhibition will make the public feel closer to significant events, while aiming to settle issues and dilute prejudices resumed over time as a result of convenience and ignorance.

The Museum building covers **6500 square meters** and was built on the place of a Greek inn at the end of the XIXth century, on Lipscani Street, in Bucharest. Nowadays, the area is a very important tourist attraction, being located in the Old Downtown of the city and close to many other tourist sites.

Through the contest, we want to identify a design solution for a permanent **exhibition space and the auxiliary areas**.

The permanent exhibition will include **artifacts, religious objects, works of art, archival documents, photographs and interactive videos** for six historical periods: Antiquity, the Early Middle Ages, Middle Ages to 1830, Modern Period (1830-1919), 1918-1945, 1945-1990.

The other functional areas are designated for: **temporary exhibitions, educational center, cultural center, a research center, library, cafeteria and books & gift shop**.



JURY



FULL MEMBERS

- ❑ Mihnea Constantinescu- the Ministry of Foreign Affairs;
- ❑ Andreea Lambru- the General Secretariat of the Romanian Government;
- ❑ Sergiu Nistor- `Ion Mincu` University of Architecture and Urbanism;
- ❑ Aurel Vainer- the Federation of Jewish Communities of Romania;

- ❑ Liviu Beris- the Association of Romanian Jews-Victims of the Holocaust;
- ❑ Virgil Nițulescu- the Ministry of Culture and National Identity;
- ❑ Florin Manole- Roma Cultural Center "O Del Amenca";
- ❑ Lucian Alexandru Găvozdea, Romanian Order of Architects

FULL MEMBERS

- ❑ Lăcrămioara Stratulat -the Moldova National Museum Complex;
- ❑ Ciprian Ștefan- the Astra Museum Complex;
- ❑ Elisabeth Ungureanu- `Elie Wiesel` National Institute for the Study of the Holocaust in Romania;
- ❑ Radu Ioanid- the United States Holocaust Memorial Museum;

- ❑ Paul Shapiro- the United States Holocaust Memorial Museum;
- ❑ Jaques Fredj- Mémorial de la Shoah;
- ❑ Rabin Andrew Baker- American Jewish Committee;
- ❑ Alexander Avram- Yad Vashem;
- ❑ Constanting Gorcea- Graphic Design Architecture, Suceava.

TIMELINE



01.10.2018
11.00 am GMT +2
Visit to the site



22.10.2018
Deadline for publishing
the answers to the
questions received



12.12.2018
Communication of the
jury's assessment of the
projects

21.09.2018
Launch of the
competition



11.10.2018
Deadline for receiving
the questions



21.11.2018
4 pm, GMT +2
Deadline for the projects



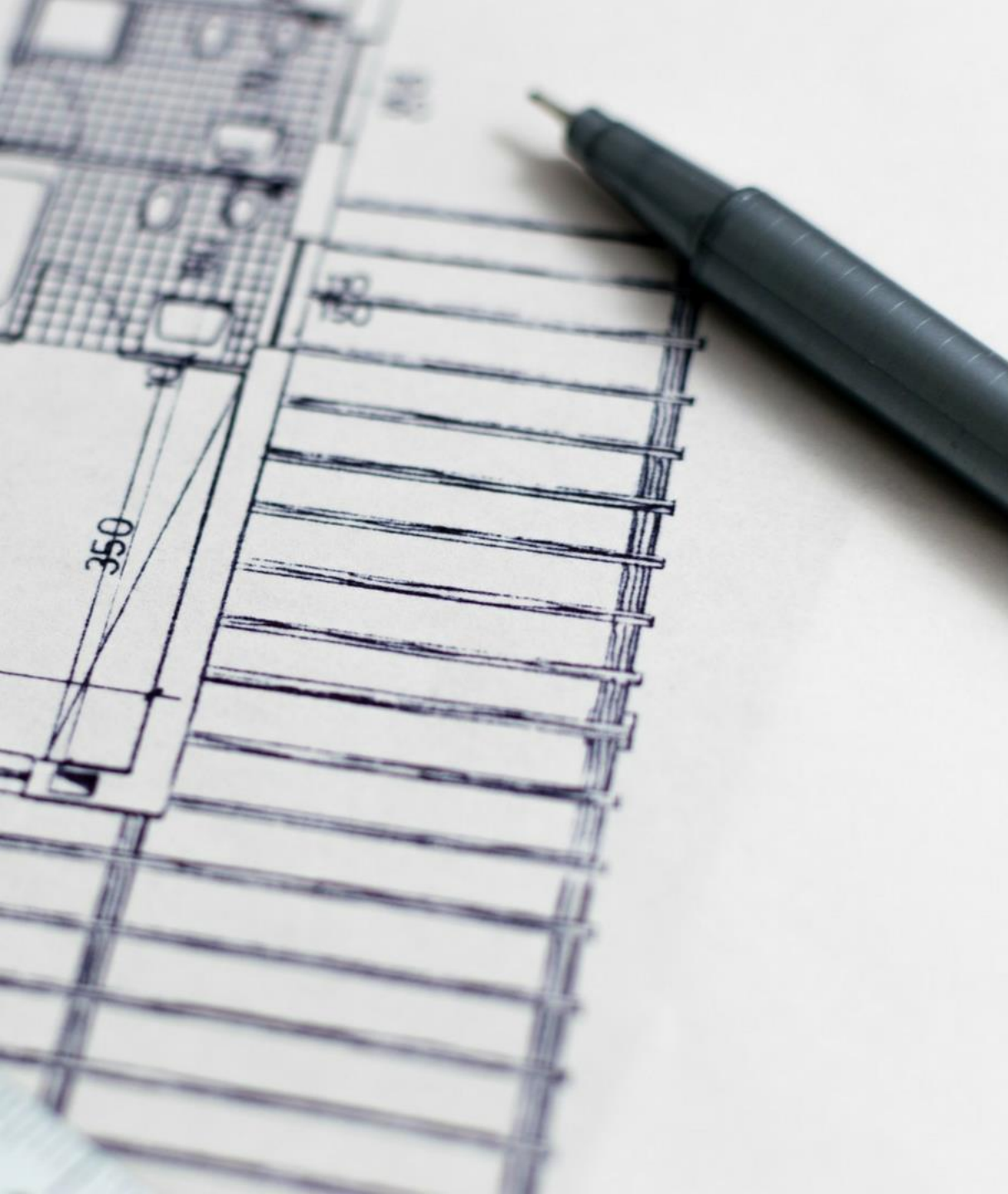

DETAILED INFORMATION

The Call for Application with full information is accessible on <http://www.inshr-ew.ro/museumcompetition/>

Communication with the organizer will be made:

- Via SEAP online platforme: www.e-licitatie.ro
- By e-mail: concur@inshr-ew.ro

The image shows a grand, classical-style building with a prominent copper dome on the left side. The building features multiple stories with arched windows and doorways, and is adorned with intricate carvings and statues. The sky is a clear, pale blue. The text is overlaid on the right side of the image in a white, serif font.

NATIONAL MUSEUM OF
THE HISTORY OF
ROMANIAN JEWRY
AND THE HOLOCAUST